

WOOD.SYSTEMS

FOR INTERIOR & EXTERIOR USE



SPREAD YOUR IDEAS

WIEHAG
TIMBER CONSTRUCTION

WOOD.SYSTEMS FOR INTERIOR AND EXTERIOR USE

HIGH QUALITY SOLUTIONS MADE FROM WOOD

Quality engineered timber solutions which are both architecturally pleasing and economically convincing, require world class products and a coherent approach. For over 160 years, WIEHAG has been manufacturing quality engineered timber systems while providing solid solutions, from consulting and production to connection details and assembly. Our state-of-the-art production facility, experienced team and stringent quality controls ensure that the highest of standards are met.

WIEHAG Engineered Timber Systems: Top Quality Products, Expertise and Service - that is the WIEHAG Complete Package.



Comprehensive advice by experienced experts.



Sophisticated total systems from a single source.



Production of individual product designs.



Production of special formats (for example, special widths of glued laminated timber).



Comprehensive service from connection details to assembly.



Page 4-7

WIEHAG GLULAM

Best wood quality, state-of-the-art manufacturing facilities for pre-cut structural systems and individual components.



Page 8-9

WIEHAG WOODY

The online calculation and ordering system for structural systems and glulam.



Page 10-13

WIEHAG PROFIDEC

Ready-to-assemble glued laminated timber systems for roofs, ceilings and walls.



Page 14-19

WIEHAG BIOLINE

The multi-layer solid wood panel for interior and exterior use.

- **Interior Applications:**
Bioline, Biofront and Biocon
- **Structural Applications:**
Profiplan
- **Exterior Applications:**
Biofas and Biogar



Page 20-23

WIEHAG TOP FORMWORK PANELS

Best in quality and in price thanks to the innovative PU-edge sealing.

OVERVIEW OF OUR WOOD.SYSTEMS



Exhibition Hall in Klagenfurt, 1966

Horseback Riding Centre Danube Valley (right):
Wedge-shaped bolsters allow the balanced
illumination of the horseback riding centre.
The glulam ceiling system of WIEHAG Profidec
achieves an optimal climate.



WIEHAG GLUED LAMINATED TIMBER

Best quality wood, state-of-the-art production facilities

From the simple glued laminated lamella to complex suspension systems

With over 60 years experience in the glued laminated timber industry, WIEHAG is one of the pioneers in the field of glued laminated wood. In 1966 WIEHAG erected the Klagenfurt Exhibition Hall. Nearly 100 m of free span construction covered an exhibition space of 7,200 m², which was at the time the largest timber construction in all of Europe. Nearly five decades later, the Klagenfurt Exhibition Hall has required practically no maintenance and is in excellent condition. It provides an impressive setting for events of all kinds and is a landmark symbol of Klagenfurt. The Klagenfurt Exhibition Hall stands as a testament to the quality and potential of sustainable engineered timber solutions from WIEHAG.

Our broad spanning competence includes:

- long-standing experience
- ultra-modern and high-tech manufacturing facility for pre-cut suspension system solutions and individual components up to 50 m in length
- internal and external quality assurance (Certified ISO 9001:2008)
- expertise of an experienced team of structural engineers, civil engineers and skilled workers
- an extensive range of products and services
- ... and last but not least our passion for wood!



WIEHAG GLULAM TYPES



STANDARD FINISHED STOCK

Definition: 12.0 or 13.5 m
Wood species: Spruce
(other species available upon request)
Product standard: EN 14080,
 DIN 1052:2008 (EN 386)
Production: in accordance with EN 386

Strength classes: in accordance with EN 1194, GL 24h
(GL 28c and higher strength classes available upon request)

Service Classes: 1 and 2

Lamination thickness: up to 41 mm

Glue: MUF glue, tested in accordance with EN 301/302

Surface qualities: exposed, natural, industrial

Moisture content: 11 ± 2 %

Dimensions: standard dimensions on finished stock see www.wiehag.com
(special dimensions upon request)

Standard lengths: 12.0 m and 13.5 m

Special lengths: up to 24.0 m (lengths of 14 meters and greater require special transport)

Standard widths: 8 to 24 cm in 2 cm increments

Standard heights: up to 48 cm in a 4 cm grid

Product identification: information is imprinted into each individual lamella
 (producer, strength, date of production)

Packaging: stocks packaged in foil *(individually-packaged upon request)*



CUSTOMISED SOLUTIONS

Definition: production of customised wood
 inventory lists *(in multiple lengths
 or individually in fixed-size cuts)*
Wood species: Spruce
(other species available upon request)
Product standard: EN 14080,
 DIN 1052:2008 (EN 386)

Production: in accordance with EN 386

Strength classes: in accordance with EN 1194, GL 24h
(GL 28c and higher strength classes available upon request)

Service Classes: 1 and 2

Lamination: up to 41 mm

Glue: MUF glue, tested in accordance with EN 301/302

Surface qualities: exposed, natural, industrial

Moisture content: 11 ± 2 %

Dimensions: standard dimensions see www.wiehag.com
(special dimensions upon request)

Standard lengths: according to cut list, max. 24.0 m, minimum length: 2.5 m

Special lengths: up to 50.0 m *(lengths greater than 14 meters require special transport)*

Multiple lengths: multiple lengths are cut to length 1 cm longer than required; the multiple-length is then limited to the maximum transport length (12.0 or 13.5 m) or the maximum length of the commission or per labelled reference positions

Widths: 8 to 26 cm; greater than 26 cm: brick or block gluing construction

Heights: up to 250 cm

Product identification: information is imprinted into each individual lamella
 (producer, strength, date of production)

Packaging: stocks packaged in foil

Please note: Our packaging foil is used primarily as transport protection, and thus only provides limited protection against UV radiation and water.



WIEHAG GLULAM

WIEHAG WOODY

WIEHAG PROFIDEC

WIEHAG BIOLINE

WIEHAG TOP
FORMWORK PANELS

GLULAM WITH PRECISION



Take some time for the essentials!
 With state-of-the-art CNC-controlled equipment we oversee your trimming needs to your specifications or according to shop plans. From simple rafters to special components, each processing step is carried out accurately and quickly. Details and an overview of possible standard processing can be found at www.wiehag.com.

GLULAM WITH STEEL PARTS



Everything from an experienced hand!
 Save time, money and hassle: Our in-house engineering department will develop standard details for steel connections which can withstand any structural analysis and which are available as a kit in a short time frame. Our clients benefit from well-conceived solutions and convenient service under one roof!

Trust **WIEHAG's certified quality** – all current certificates can be found at www.wiehag.com!

WIEHAG WOODY

The online calculation & ordering system for our structural suspension systems and glulam products

The exclusive service for our premium customers!

With WOODY you can create simple and easy calculations for structural systems and standard glulam products in seconds. You quickly get a quote in PDF file format. All you need is a PC with internet access and your personal access code which you can obtain from your WIEHAG partner. WOODY is a free web application which requires no local installation. Test for yourself and take the WOODY tour at www.woody.cc.

WOODY: What are the advantages?

- **Accurate offers in seconds:** Exclusive service for premium customers - at any time, any place.
- **Exact price:** By connecting to our internal calculation system, the prices of our glulam components can be obtained quickly and accurately.
- **Available as PDF file format:** With WOODY you can obtain your quote conveniently in PDF file format. The PDF file contains the same information as the one created by your WIEHAG partner.
- **Interactive collaboration and support:** If you ever have any questions about a project, please do not hesitate to contact your WIEHAG partner.
- **Request delivery status and tour:** With our PPS system you can follow the production and delivery status of your order.
- **Open interfaces:** It is possible to establish an individual interface between your ERP system and WOODY.

WIEHAG WOODY
An interactive tool for
offers and calculations



WOODY „Login“

How to access WOODY?

Contact your WIEHAG partner - they will organise your input data and explain the WIEHAG online ordering system at your location. Now you can use WOODY quickly and efficiently!



WOODY „structural suspension system calculation“

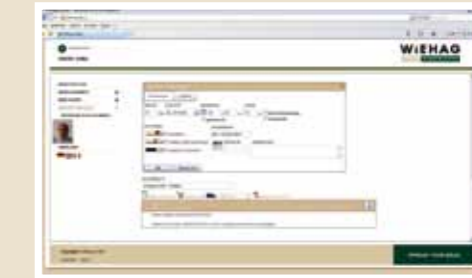

WOODY „create an offer“

**Exclusive
service
for selected
clients**

ALL AT A CLICK

WIEHAG PROFIDEC

The assembly-ready laminated timber system for roof, ceiling and wall

With high pre-fabrication and shortened assembly time, the glulam element Profidec is ideal for use in residential, commercial and industrial construction.

Advantages:

- High degree of pre-fabrication
- Short installation time
- No building moisture
- Immediately accessible and load-bearing
- Controlled fire resistance
- Installation of HVAC / insulation at any time
- Structural shear plane

Our service to the Master Carpenter:

- Planning service
- Structural analysis
- Customized CNC trimming options
- Pre-installation aids (RAMPA connectors)

Technical data:

Wood species:	spruce (<i>larch, Douglas fir, pine and fir upon request</i>)
Lengths:	minimum length 2.50 m (up to 24 m)
Widths:	standard width: 60 to 80 cm (<i>special widths between 24-120 cm upon request</i>)
Strength:	GL 24h according to EN 1194
Surface qualities:	exposed, natural, industrial
Fire safety:	in accordance with EN 13501 Euro Class D Smoke class s2 Dripping Class d0 The burning rate β_0 is 0.7 mm/min in accordance with EN 1995-1-2
Noise control:	depending on the construction, up to 52 db possible
Acoustic surface:	absorbing surface; possible supplemental features include the installation of hanging modules
Source and shrinkage measurements:	The calculated value for the swelling and shrinking in thickness and width is 0.24% per 1% change in the moisture content, in accordance with DIN 1052:2004-08. The moisture content in production is $11 \pm 2\%$.



Production Hall for "Weißhaidinger Engineered Timber": WIEHAG Freespan girders combined with WIEHAG Profidec roof elements made of pine and an acoustic surface



Standard Surface



Acoustic Ceiling



Wall Unit

WIEHAG PROFIDEC

Structural Measurement Charts

The charts below are for preliminary structural measurements only, a vibration value according to Eurocode 5 is required.

All figures refer to the load duration "short" and service class „1“. The permissible span is measured in meters (= clear width + 10 cm).

Use as a single span system

Ceiling thickness	1,50	2,00	2,50	3,00	3,50	4,00	4,50	5,00	5,50	6,00	6,50	7,00	7,50	8,00	*
06 cm ¹⁾	2,95	2,71	2,54	2,41	2,29	2,20	2,12	2,05	1,99	1,94	1,89	1,85	1,80	1,77	
07 cm ¹⁾	3,42	3,16	2,96	2,81	2,68	2,57	2,48	2,40	2,33	2,27	2,21	2,16	2,11	2,07	
08 cm ²⁾	3,89	3,60	3,38	3,20	3,06	2,94	2,83	2,74	2,66	2,59	2,53	2,47	2,42	2,37	
09 cm ²⁾	4,35	4,03	3,79	3,60	3,44	3,30	3,19	3,09	3,00	2,92	2,85	2,78	2,72	2,67	
10 cm ²⁾	4,81	4,46	4,20	3,99	3,81	3,66	3,54	3,43	3,33	3,24	3,16	3,09	3,02	2,96	
12 cm ²⁾	5,69	5,30	5,00	4,75	4,55	4,38	4,23	4,10	3,99	3,88	3,79	3,70	3,63	3,55	
14 cm ³⁾	6,64	6,20	5,86	5,58	5,35	5,16	4,98	4,83	4,70	4,58	4,47	4,37	4,28	4,20	
16 cm ³⁾	7,48	7,00	6,63	6,32	6,07	5,85	5,66	5,49	5,34	5,21	5,09	4,98	4,87	4,78	
18 cm ³⁾	8,29	7,79	7,38	7,05	6,78	6,54	6,33	6,14	5,98	5,83	5,70	5,57	5,46	5,36	
20 cm ³⁾	9,09	8,55	8,13	7,77	7,47	7,21	6,99	6,79	6,61	6,45	6,30	6,17	6,04	5,93	
22 cm ³⁾	9,87	9,31	8,85	8,48	8,16	7,88	7,64	7,43	7,23	7,06	6,90	6,76	6,62	6,50	
24 cm ³⁾	10,63	10,05	9,57	9,18	8,84	8,54	8,29	8,06	7,85	7,67	7,50	7,34	7,20	7,06	

Use as a three-field system

CAUTION: Load case only valid in the roof!

Ceiling thickness	1,50	2,00	2,50	3,00	3,50	4,00	4,50	5,00	5,50	6,00	6,50	7,00	7,50	8,00	*
06 cm ¹⁾	3,78	3,48	3,26	3,09	2,94	2,83	2,72	2,64	2,56	2,49	2,43	2,37	2,32	2,27	
07 cm ¹⁾	4,37	4,03	3,78	3,58	3,42	3,29	3,17	3,07	2,98	2,90	2,83	2,76	2,69	2,64	
08 cm ²⁾	4,95	4,58	4,30	4,07	3,89	3,74	3,61	3,49	3,39	3,30	3,23	3,14	3,06	3,01	
09 cm ²⁾	5,52	5,11	4,81	4,56	4,36	4,19	4,05	3,92	3,81	3,70	3,62	3,53	3,44	3,38	
10 cm ²⁾	6,08	5,64	5,31	5,04	4,83	4,64	4,48	4,34	4,22	4,10	4,00	3,91	3,82	3,75	
12 cm ²⁾	7,18	6,68	6,30	6,00	5,74	5,53	5,34	5,18	5,03	4,90	4,79	4,67	4,56	4,49	
14 cm ³⁾	8,24	7,70	7,28	6,93	6,65	6,40	6,19	6,00	5,84	5,69	5,56	5,43	5,32	5,21	
16 cm ³⁾	9,28	8,69	8,23	7,85	7,54	7,26	7,03	6,82	6,64	6,47	6,32	6,18	6,05	5,94	
18 cm ³⁾	10,30	9,67	9,17	8,76	8,41	8,12	7,86	7,63	7,43	7,24	7,12	6,92	6,79	6,65	
20 cm ³⁾	11,29	10,62	10,09	9,65	9,28	8,96	8,68	8,43	8,21	8,01	7,80	7,66	7,52	7,36	
22 cm ³⁾	12,25	11,56	10,99	10,53	10,13	9,79	9,49	9,22	8,98	8,77	8,54	8,39	8,23	8,07	
24 cm ³⁾	13,20	12,47	11,89	11,39	10,97	10,61	10,29	10,01	9,75	9,52	9,31	9,12	8,91	8,77	

Values are only valid for uniform load distribution (e.g. for use in the roof area). For use in areas with load cases in the ceiling area, dimensions must be calculated in advance!

Profile Overview/Milling

For use in the roof area

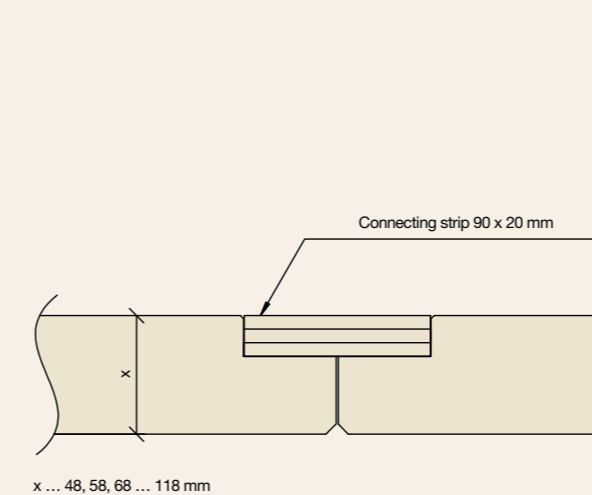

1) Elements without tongue-and-groove milling, cross-section is separated, topside rough sawn

For ceilings with smaller spans

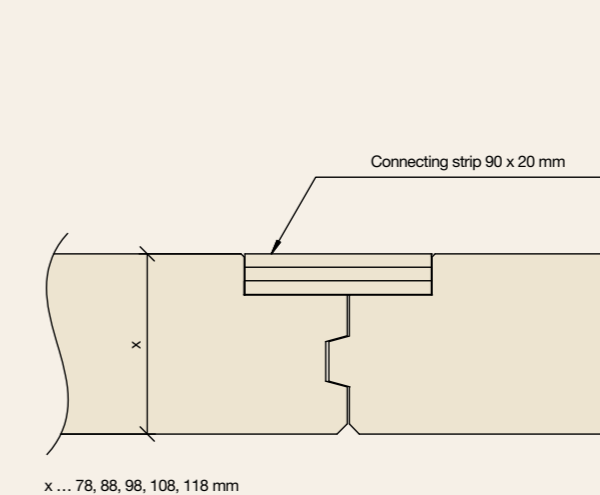

2) Elements with a tongue-and-groove milling, cross-section is separated, topside rough sawn

For ceilings with larger spans and / or increased fire protection requirements

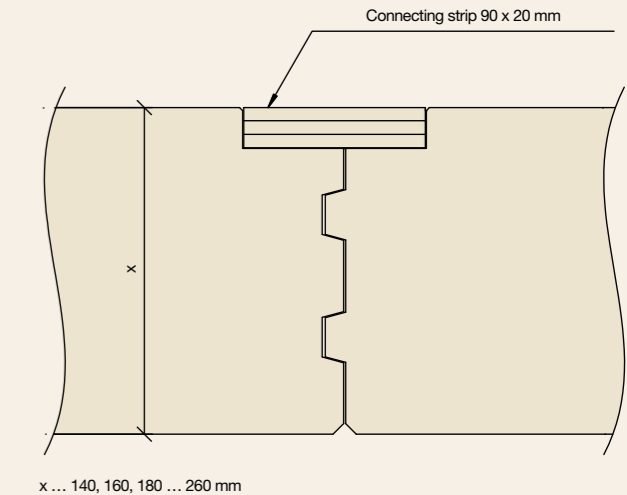

3) Elements with 2-fold tongue-and-groove milling, full cross-section, topside planed

* **Total super-imposed load on WIEHAG Profidec in kN/m² including ceiling /roof or pay/snow load**
(Dead weight of Profidec is already considered)

Parameters:

- Deflection max. L/300
- Load duration: short
- Dead weight of Profidec is already included in the calculation!
- Creep deformation is not considered!
- Wood Species: spruce, strength class GL 24h
- E-Module 11000 N/mm²
- Continuously load bearing!
- Permissible bending stress 11 N/mm²
- Occurring vibration values due to loads are to be considered separately!
- The values are used for preliminary measurements; they do not replace structural verification!



New Exhibition Hall Karlsruhe: 80 m free span arched truss, combined with WIEHAG Profiplan (as a structural, visible roof soffit)



WIEHAG BIOLINE

The multi-layer solid wood panel for interior and exterior use

WIEHAG Bioline is a multi-layer solid wood panel for interior and exterior use and is manufactured in accordance with EN 13986, EN 13353 and EN 13017-1. Since varying requirements with regards to glueing and wood moisture level cannot be met with one solution, we at WIEHAG decide during the wood drying process which panel will be used for which application. For example, for outdoor applications we dry lumber at approximately 12%. For indoor use at approximately 8%; ideal to sufficiently prevent warping and cracking. Another distinction is made with regards to bonding (glueing). For outdoor applications, the most resilient bonding condition is applicable, while the internal application requires a low-formaldehyde glue.

Benefits of WIEHAG Bioline natural wood panels:

Large-scale / efficient and quick to execute / sustainable and PEFC certified building material / healthy indoor climate

Area of application of Bioline - an overview:

- **For interior use:** Bioline, Biofront and Biocon (with a moisture content of 8% and a low-formaldehyde glue in accordance with EN 13353; knot-free and thermal-treated version upon request)
- **For construction use:** Profiplan (with a moisture content of 10% and glueing in accordance with EN 13353)
- **For exterior use:** Biofas and Biogar (with a moisture content of 12% and a special bonding in accordance with EN 13353)

Our services:

Consulting Service / Application Technology (please refer to our processing information at www.wiehag.com) / Cutting Optimization / Cutting / Special Handling / Commissions / Delivery

Special services: brushing, glazing, bevelling and much more

FROM NATURE & IN HARMONY WITH NATURE



WIEHAG BIOLINE FOR INTERIOR AND STRUCTURAL USE

BIOLINE - THE UNIVERSAL NATURAL TIMBER PANEL



Area of application: ceiling, walls, floors, furniture and interior fittings, eaves and general construction use

Advantages: large scale, fast and efficient processing, reduced cracking (due to externally defined right side); hygroscopic, healthy living environment

Strengths: 17, 20, 26, 30, 38, 40, 50 mm (*other thicknesses upon request*)

Construction: 3-layer

Panel design (examples)

17 mm 5,5 / 6 / 5,5 mm **38 mm** 8,3 / 21,4 / 8,3 mm

20 mm 5,5 / 9 / 5,5 mm **40 mm** 8,3 / 23,4 / 8,3 mm

26 mm 8,5 / 9 / 8,5 mm **50 mm** 8,3 / 33,4 / 8,3 mm

30 mm 8,3 / 13,4 / 8,3 mm

Sizes (L x W): 500 x 125 cm (*other sizes upon request*),

special lengths > 500 cm possible with general finger joint (not CE compliant)

Wood species: Nordic spruce, native spruce, northern pine, Siberian larch, European Douglas fir; find detailed information on the weight of the individual wood species and strengths at www.wiehag.com

Wood quality: in accordance with EN 13017-1, from O/O to C/C (see table on the right), visibly attractive sides closed with natural-knot dowels; jointed and glued, top layer with board characteristics

Finish: sanded K60, optional: touch-up K120 / brushed one side / different profiles and glazes

Moisture content: approximately 8–10 %

Glueing: in accordance with EN 13353 (glueing process SWP/3)

Packaging: strengths of 17 to 26 mm: 20 pieces per package (foiled)
strengths of 30 to 50 mm: 10 pieces per package (foiled)

Overview of our wood qualities

thickness in mm	17	20	26	30	38	40	50
O/O	•	•	•	•			
O/A	•	•	•	•			
A/A	•	•	•	•	•	•	
A/B	•	•	•	•	•	•	
A/C	•	•	•	•	•	•	
AB/B	•	•	•	•	•	•	
B/B	•	•	•	•	•	•	•
B/C	•	•	•	•	•	•	•
C/C	•	•	•	•	•	•	•

BIOCON - FOR STRUCTURAL USE



Area of application: roofing and roof sheathing, hall ceilings, wall construction, subfloors, industrial floors, etc.

Advantages: highly versatile, rapid installation, different-cut rates, reduced cracking (due to externally defined right side), hygroscopic, healthy living environment

Strengths: 17, 20, 26, 30, 38, 40, 50 mm (*other thicknesses upon request*)

Sizes (L x W): 500 x 125 cm (*other sizes upon request*), special lengths > 500 cm with general finger joint (not CE compliant)

Wood species: Native spruce; find detailed information on the weight of the individual wood species and strengths at www.wiehag.com

Wood quality: in accordance with EN 13017-1, on one side closed with natural-knot dowels; jointed and glued, top layer with board characteristics

Finish: sanded K60, optional: touch-up K120 / brushed one side / different profiles and glazes

Moisture content: approximately 8–10 %

Glueing: in accordance with EN 13353 (glueing process SWP/3)

Packaging: strengths of 17 to 26 mm: 20 pieces per package (foiled)
strengths of 30 to 50 mm: 10 pieces per package (foiled)

BIOFRONT - FRONT PANEL FOR FURNITURE



Area of application: furniture fronts

Advantages: sturdy, exclusive wood quality, reduced cracking on the exposed side (due to externally defined right side); hygroscopic, healthy living environment

Strength: 20 mm

Sizes (L x W): 500 x 125 cm (*other sizes upon request*)

Wood species: Nordic spruce, northern pine; find detailed information on the weight of the individual wood species and strengths at www.wiehag.com

Wood quality: in accordance with EN 13017-1, O/B, visible sides closed with natural-knot dowels; jointed and glued, top layer with board characteristics

Finish: sanded K60, optional: touch-up K120 / brushed one side / different profiles and glazes

Moisture content: approximately 8–10 %

Glueing: in accordance with EN 13353 (glueing process SWP/3)

Packaging: 20 pieces per package (foiled)

PROFIPLAN - TIMBER PANEL FOR FORMWORK AND CONSTRUCTION APPLICATIONS



Area of application: visible, load-bearing and consolidated cladding

Advantages: quick installation; in combination with primary structure: supporting, consolidating element with a decorative finish (static values in accordance with EN 13353); reduced cracking (due to externally defined right side)

Strengths: 17, 20, 26, 30, 38, 40, 50 mm

Sizes (L x W): 500 x 125 cm (*other sizes upon request*), special lengths > 500 cm with general finger joint (not CE Compliant)

Wood species: Nordic spruce, native spruce, Siberian larch; find detailed information on the weight of the individual wood species and strengths at www.wiehag.com

Wood quality: in accordance with EN 13017-1, on one side closed with natural-knot dowels; jointed and glued, top layer with board characteristics

Finish: sanded K60, optional: touch-up K120 / brushed one side / different profiles and glazes

Moisture content: approximately 8–10 %

Glueing: in accordance with EN 13353 (glueing process SWP/3 - supporting)

Packaging: strengths of 17 to 26 mm: 20 pieces per package (foiled)
strengths of 30 to 50 mm: 10 pieces per package (foiled)

Optional services: consulting, design, project management, structural engineering



WIEHAG BIOLINE. FOR EXTERIOR USE

BIOFAS – MULTI-LAYER SOLID TIMBER PANEL FOR THE FACADE



Area of application: ventilated cladding for large-area facades in protected outdoor environments

Advantages: quick installation, planar character

Strengths: 17, 20, 26 mm

Sizes (L x W): 500 x 125 cm, 250 x 125 cm, 250 x 62,5 cm (*other sizes available upon request*)

Wood species: Nordic spruce, native spruce, Northern pine, Siberian larch, European Douglas fir

Wood quality: in accordance with EN 13017-1, one side visibly attractive - closed with natural-knot dowels; jointed and glued, top layer with board characteristics

Finish: sanded K60, optional: touch-up K120 / brushed one side / different profiles and glazes

Moisture content: 12 +/- 2 %

Glueing: in accordance with EN 13353 (glueing process SWP/3 - supporting)

Packaging: 20 pieces per package (foiled)

Fixing: In addition to the standard mounting system onto the timber sub-structure (minimum of 20 mm ventilation), the WIEHAG mounting system enables the fasteners to remain unseen which allows a more visually appealing fixing: Mounting System with 3 mounting hardware components (wall anchors, angle section, hinge profile; variations: wall anchors in three different sizes to provide ideal thermal insulation solutions)



Wall Anchor



Angle Profile



Hinge Profile

BIOGAR – A MULTI-LAYER SOLID TIMBER PANEL FOR UNIVERSAL APPLICATIONS



Area of application: shutters, garage doors, garden sheds

Advantages: quick installation, planar character, two decorative visible sides

Strengths: 17, 20, 26 mm

Sizes (L x W): 500 x 125 cm (*other sizes available upon request*)

Wood species: Nordic spruce, native spruce, Northern pine, Siberian larch, European Douglas fir

Wood quality: in accordance with EN 13017-1, both sides visibly attractive quality - closed with natural-knot dowels; jointed and glued, top layer with board characteristics

Finish: sanded K60, optional: touch-up K120 / brushed one side / different profiles and glazes

Moisture content: 12 +/- 2 %

Glueing: in accordance with EN 13353 (glueing process SWP/3 - supporting)

Packaging: 20 pieces per package (foiled)

APPLICATION AND INSTALLATION FOR BIOFAS

Must be installed vertical to the grain. Water must be able to immediately run off freely. The general requirements of constructional timber protection and our notes at www.wiehag.com must be observed.

WIEHAG BIOLINE. FOR INTERIOR AND CONSTRUCTION USE



WIEHAG TOP formwork panels for a variety of custom applications (here for example in the colour red)



WIEHAG TOP FORMWORK PANELS

Best in quality and cost effectiveness

WIEHAG TOP formwork panels meet the highest building requirements.

Our commitment to quality and innovation is evident in such features as the PU-edge sealing, in the 3 x 9 mm construction and in the hardest abrasion-proof surface all of which enable more dimensional stability, efficiency and durability. Thus, the WIEHAG TOP formwork panel is the ideal solution - for concrete formwork, for staging, vehicle bodies as well as shelving, pallet bases and tent floors.

BENEFITS you can build on:

- **Cost Savings:** up to € 30,-/m² and greater due to the extremely hard panel surface which maximises repeat usage.
- **Unique WIEHAG Colour Scheme:** our formwork panels are available in yellow as well as in seven additional colours (at a surcharge) for clear identification as a high quality formwork panel, thus avoiding premature cutting on site.
- **Additional Cost Savings** (approximately 20%) made possible by **reducing the need for additional steel substructure/bracing** through the structurally optimized design of 3 x 9 mm.
- **Cutting Precision:** accuracy made possible by state-of-the-art manufacturing technologies.
- **Variety of Formats:** WIEHAG formwork panels are available in several sizes (small, large and custom sizes).
- **Improved Stability/Impact Resistance** due to the continuous middle layer; no chipping of edges.
- **Branding & Theft Protection:** surface enables printing (in grey) of your company name to enhance brand exposure and reduce theft.

ECONOMICAL, STURDY, DURABLE



WIEHAG TOP FORMWORK PANELS



Production:	in accordance with EN 13353 and EN 13017-1
Structure:	symmetrical design of selected wood lamellae (3 x 9 mm), alternative thicknesses (e.g. 21 mm) and custom strengths also available
Formats:	<ul style="list-style-type: none"> — Small sizes 50 cm width, Lengths: 100, 150, 200, 250, 300 cm — Large sizes 50 cm width, Lengths: 350, 400, 450, 500 cm — Large sizes 100 cm width, Lengths: 100, 150, 200, 250, 300, 400, 450, 500 cm — Custom sizes up to max. 125 cm width and 500 cm length; custom cuts upon request
Colours:	Standard finish colour: yellow (seven additional colours upon request), PU-sealed edges: grey

Surface Colour Options:

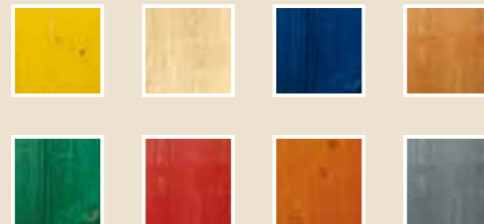

WIEHAG TOP WITH PU-EDGE SEALING

WIEHAG sets standards in quality and profitability with PU-edge sealing.

The grey PU-edge sealing

- saves time and cost by simplifying cleaning,
- prevents the edge from discolouring the concrete,
- reduces cracking and fissures
- and reduces moisture absorption.

WIEHAG FORMWORK GIRDERS

The Solution for all Requirements

Robust, solid-walled general purpose formwork girders with rounded corners for formwork for walls and ceilings

H20-TIMBER GIRDER

- Height: 200 mm
- Girder: 40 x 80 mm
- Flange: 31 mm
- Lengths: 245, 290, 330, 360, 390, 450, 490, 590 cm
- With building inspection authorization

Note: No colour choice!



Example of slab formwork

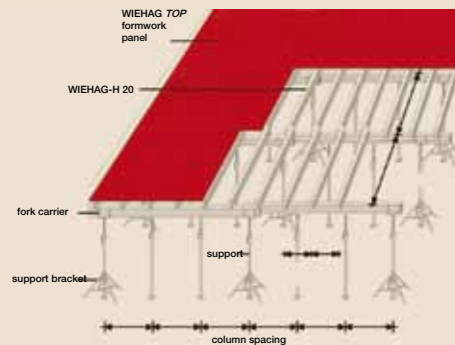



Please contact us for further information!

WIEHAG GmbH, Linzer Straße 24, 4950 Altheim, Austria
Tel +43 (0) 7723/465-0, Fax +43 (0) 7723/465-638
E-Mail: office@wiehag.com, www.wiehag.com

SPREAD YOUR IDEAS

WIEHAG
TIMBER CONSTRUCTION